

STEP BY STEP

Cleaning *and* Waxing Hard Surface Floor Coverings

SWEEP FLOORS



For easy cleaning, wax dustpan
and dirt will slide off.

— TEXAS A&M UNIVERSITY —
TEXAS AGRICULTURAL EXTENSION SERVICE
J. E. Hutchison, Director, College Station, Texas

Instructions here only for linoleum, asphalt, vinyl, vinyl-asbestos, NOT WOOD FLOORS

Read labels— Some waxes damage asphalt tile

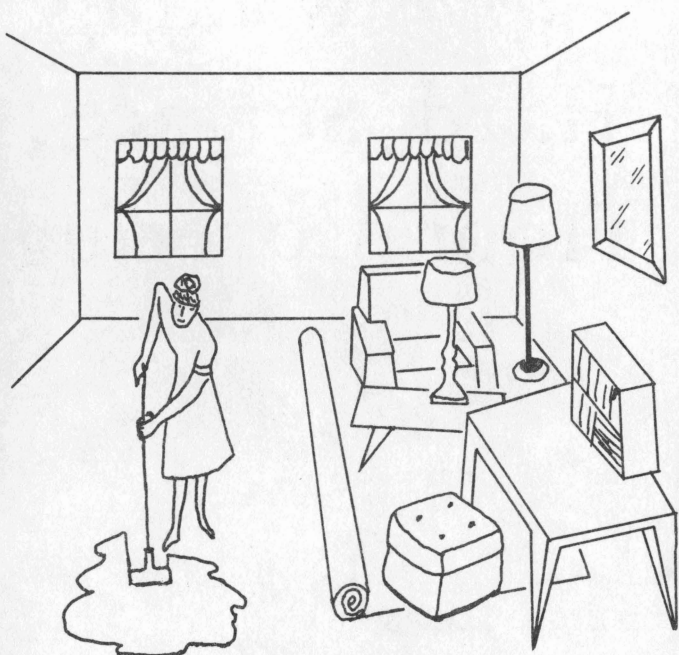

Push furniture to one side; wash half of floor. For easy cleaning use 1/4 cup detergent and 3 tablespoons ammonia in pail of cool water.

Rinse floor and let dry for 20 minutes.

Move furniture to clean side and repeat.

Change water often.

WAXING FLOORS

Waxing is not necessary. If you prefer the high gloss of a wax finish they may be waxed.

Apply a small amount of wax and spread in a thin even coat with a cloth or wax applicator.

A long-handled waxer will make the job easier.

Allow 20 minutes to dry.

Wash floors and wax only when needed.

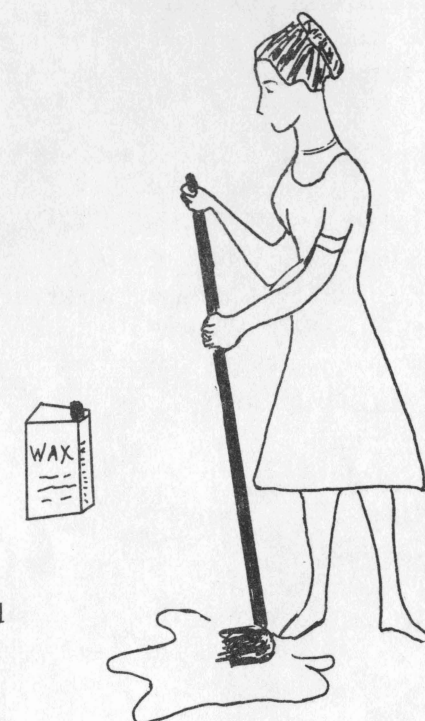

To remove heel marks --
Moisten cloth or sponge with one of the concentrated cleaners. Rub the mark until it disappears. Rinse well.

USE THESE TOOLS

Broom and dustpan
Mop and pail
Cloths

USE THESE SUPPLIES TO WASH

Warm water + one cleaner of
this type:

Ajax with ammonia
Borax
Handy Andy
Lestoil
Soil-off
Spic and Span
Washing Soda

USE THESE SUPPLIES TO WAX

On dry clean floor, use one of
these liquid waxes such as:

Aero-Wax
Armstrong One Step
Beacon Wax
Butcher Liquid Wax
Johnson's Klear
Preen
Follow directions on can.

Prepared by Home Management Specialists, Agricultural Extension Service, Texas A&M University, College Station, Texas.

Credit is given to: Florence Walker, Home Management Specialist and Mrs. Luberta Sims, Director, Homemaking Program, New Haven Redevelopment Agency.

This leaflet was originally published by the Cooperative Extension Service, College of Agriculture, The University of Connecticut, Storrs, Connecticut.

The information given herein is supplied with the understanding that no product discrimination is intended and that no endorsement of a product by the Texas Agricultural Extension Service is implied.

Cooperative Extension Work in Agriculture and Home Economics, Texas A&M University and the United States Department of Agriculture cooperating. Distributed in furtherance of the Acts of Congress of May 8, 1914, as amended, and June 30, 1914.